

Electric Mini Grinder "RAIJIN SLIM"



Instruction

Thank you for purchasing our product!
Please read all instructions carefully before using the product to ensure safe and proper use.
After reading this instruction, please save it and make them available to users of this tool.

Part No.
GR-M58(75)RS

2020. 12

NRS **NEW REGISTON**

2-1-1 AYUMINO IZUMI-CITY OSAKA 594-1157 JAPAN
HOMEPAGE <https://www.newregiston.co.jp/en/>



Accessories

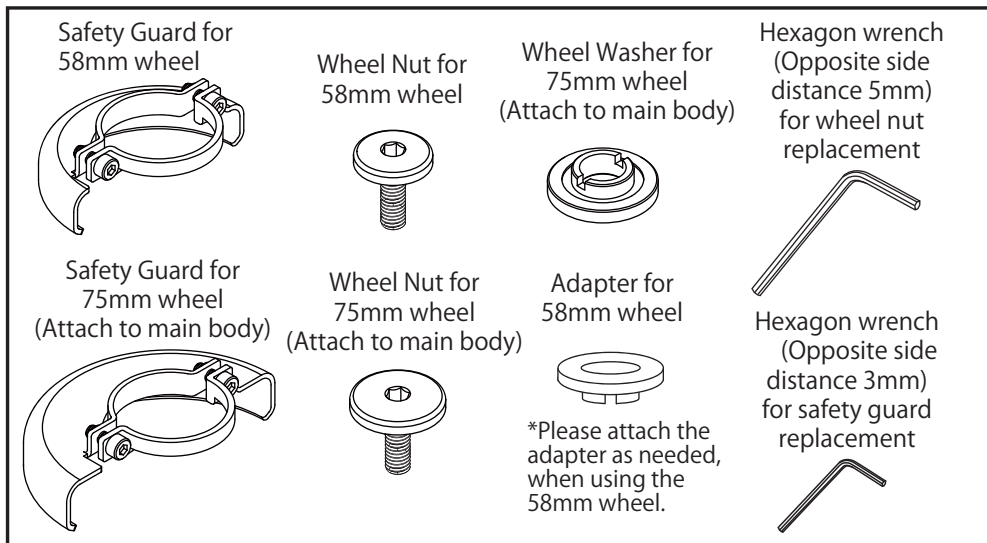

Specification

Part No.	GR-M58(75)RS
Wheel Size	58 × 3.5 × 9.53 mm 75 × 5 × 9.53 mm
Power source	50 / 60 Hz
Rated voltage	100 V
Power consumption	400 W
No Load Speed	10,000 min ⁻¹
Basic Machine Mass	1.0 kg
Grip Diameter	49 mm
Overall Length	236 mm

Dual insulation

*Please use safety guard (optional part), wheel nut (optional part) and wheel washer (optional part), when you use THETA MINI with GR-M58(75)RS.

*Specifications (including design) may change without notice.

Diagram and Parts List

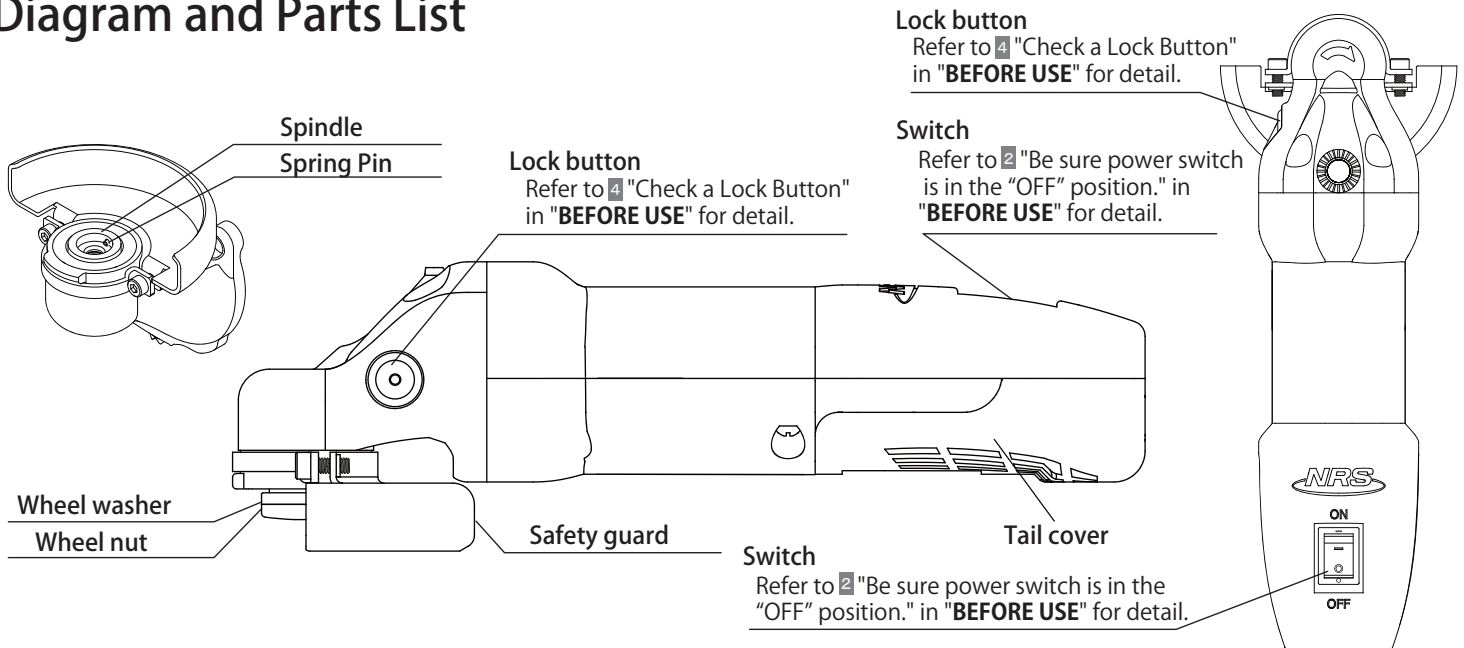

IMPORTANT SAFETY RULES FOR PROPER USE OF ELECTRIC TOOLS

Electric tool is a safety tool if the tool is used properly. Improper use or careless handling may cause accidents such as fire, electrification and injury. Please follow the rules below for your safety. The following safety rules are based on Japanese "Industrial Safety and Health Standard" and "Grinding Machine.

 **WARNING: IMPROPER USE MAY CAUSE DEATH OR SERIOUS INJURY.**

1. Keep your work area clean and well lit. Do not use the tool in cluttered benches and dark areas it may invite accidents.
2. Do not operate the tool in the rain, wet area and explosive atmospheres.
3. Be mindful of electric shock.
4. Keep non-worker or children away from working area. Never allow them to touch a electric tool or cord.
5. Store idle tools in a safe, dry location out of reach of children.
6. Use only wheels which meet the specified dimension and RPM capacity of the grinder.
7. Use the correct tool for your application. Do not use the tool for anything other than its intended use.
8. Do not wear loose clothing or jewelry. Contain long hair. Loose clothes, jewelry or long hair can be caught in moving parts. Secure long hair with nets or caps.
9. Use safety equipment such as safety helmet, safety glasses, dust mask, ear protection, protective gloves and safety shoes.
10. Do not damage the power cord and plug. It may cause electric shock, short circuit or fire.
11. Do not overreach. Keep proper footing and balance at all times.
12. Maintain Electric tool carefully.
 - Observe the instructions for lubricating and changing accessories.
 - Regularly inspect cord. If damaged, contact your supplier where you purchased the product for repair.
 - When using an extension cord, inspect the cord regularly. If damaged, replace it with new one.
 - Keep the grip clean, dry, and free from oil and grease at all time.
13. Turn off switch and unplug the power plug from the power outlet when not in use or servicing a tool, changing the wheels or accessories and other hazardous situations.
14. Disconnect the air hose from the tool before turning on the power, removing or adjusting any accessory on the tool.
15. Make sure the switch is off before plug the machine, avoid accidental starting.
16. Select the extension cord that is suitable for outdoor use.
17. Watch what are you doing, and stay alert when operating the tool. Do not use the tool while tired.
18. Check for damaged parts.
 - Be carefully checking safety guard or other parts have a damage and determine that it will operate properly and perform its intended function before using the machine.
 - Check for alignment of moving parts, binding of moving parts, breakage of parts, and any other conditions that may affect its operation.
 - Follow the instructions in the manual for replacement or repair of damaged wheel cover or other parts. If there is no instruction, contact the dealer where you purchased the product for repair.
 - Do not use the tool that cannot start or stop by switch.
19. Do not use accessories that are not listed in this instruction or our catalog. Using the wrong accessories may cause an accident or injury.
20. Do not modify this tool in any way. The tool has complied with safety standards. Consult your supplier for repair.

*These products are made for Japanese market,cannot be purchased or used outside Japan.
Use outside Japan may not be able to deliver original performance. Also, No repair service or warranty are available outside Japan.

BEFORE USE



Check the following before use, particularly items 1 to 5 check before plug the machine.

1 Check the power source.

Make sure to use the machine with the voltage specified on a label attached to the main unit. Failure to use the machine at the proper voltage cause motor to run at excessive speed and result in wheel or machine breakage. Do not use direct current. It may cause machine breakage and an accident.

2 Be sure power switch is in the "OFF" position.

If machine is plugged while the switch is on, the machine will start accidentally and invites accidents. Make sure switch is in the "OFF" position.

3 Always use a safety guard.

A safety guard protects operator from broken wheel fragments. Always make sure a safety guard is in place. The angle of safety guard can be adjusted by loosening screw. Please set it at an angle suitable for work. Tighten the screw properly after adjustment.

Caution: Use a proper safety guard which matches the wheel size.

4 Check a Lock Button

Make sure that the lock button is disengaged by pushing lock button.

5 Check and Mounting Wheel

Use an authentic wheel. Do visually inspect the wheel before mounting for possible damage, such as cracking or chipping. Make sure the wheel is mounted and tightened properly.

When you mount wheel, please refer to the section "Mounting and Removing a Grinding Wheel".

6 Outlet Inspection

When the plug is loose or falling out of outlet easily, prompt repair is needed. Overheat may be caused with continued use and result in an accident.

7 Perform a Test Run

The use of cracked or chipped wheel is very dangerous. Always perform a test run in a safe place to make sure there are no problems.

■ Duration of the test run

When starting daily work	1 minute or more
When grinding wheel is replaced	3 minutes or more

Caution: Always make sure the rotating part does not contact with a workpiece before turning on the power. Turning on the switch while contact may cause wheel breakage and result in an injury. When you switch on the tool for the first time, please keep your body away temporary from exposure parts of grinding wheel by all means.

Mounting a Optional Accessory



Make sure to turn off the switch before unplug.

- Please follow the instructions of each product to mount the optional accessories properly.
- Always make sure to use protective equipment with the optional accessories.
- Always make sure not to exceed the maximum operating speed and maximum allowable rotation. If it exceeds the maximum peripheral usage speed displayed on the wheel, please do not use.

Mounting and Removing a Grinding Wheel

Make sure to turn off the switch before unplug.

1. Mounting a Wheel

- Tighten the wheel nut by using the supplied wrench.
- Make sure to use the supplied wheel washer and wheel nut together with 75mm wheel.
- Use a proper safety guard which matches the wheel size.

Mounting 58mm wheel

Turn the grinder upside down so that the spindle is facing upward. Put the protuberance of 58mm wheel nut onto the wheel hole and mount them on the spindle. When mounting adapter for 58mm, put the spring pin in the groove at this time and mount them.

Mounting 75mm wheel

- 1 Turn the grinder upside down so that the spindle is facing upward. Put the 75mm wheel washer on the spindle. Then put the spring pin in the groove and mount them.
- 2 Fit the protuberance of wheel nut onto the wheel and screw the wheel nut onto the spindle.

2. Removing a Wheel

To remove the wheel, simply reverse the above-mentioned procedure.

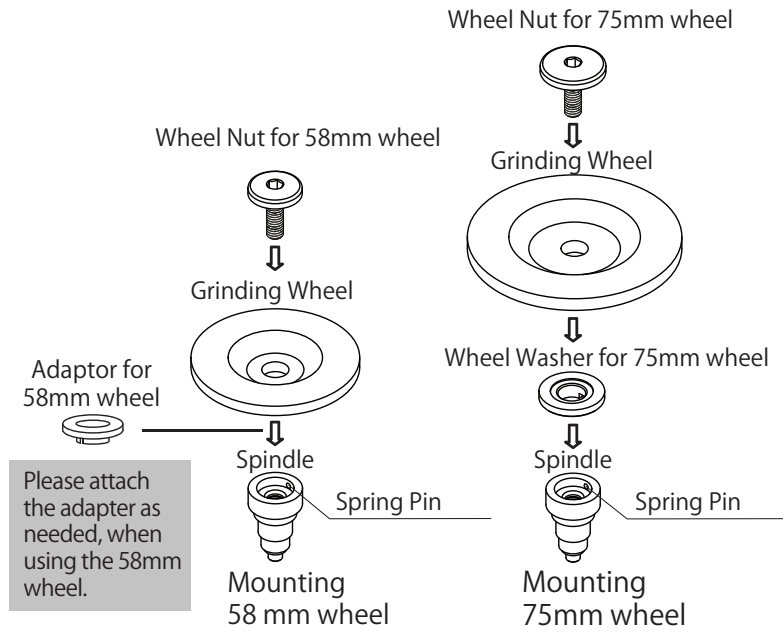

Caution: Make sure the lock button return to the original position when releasing it after pressing.

Maintenance and Inspection

Make sure to turn off the switch before unplug.

1. Inspect screws on the tools

Regularly inspect all screws and ensure that they are fully tightened.

2. Inspection / Replacement of Carbon Brush

When the carbon brush worn out and become shorter, replace it with new one. The significant wear may cause motor failure. When replacing the carbon brush holder, replace both the right and left sides. Make sure use the carbon brush holder specified by NRS.

● How to Replace a Carbon Brush Holder

- Open the tail cover using a screwdriver, then take the carbon brush holder straight up to remove it from the machine. (Figure1)
- Unplug the connection terminals of wiring [blue] and [yellow], and replace right and left sides with a new carbon brush holders. Insert the connection terminals in the reverse order of the above. (Figure2)
- Push the carbon brush into the machine. Make sure the carbon brush holder is mounted securely and close the tail cover. (Figure3)

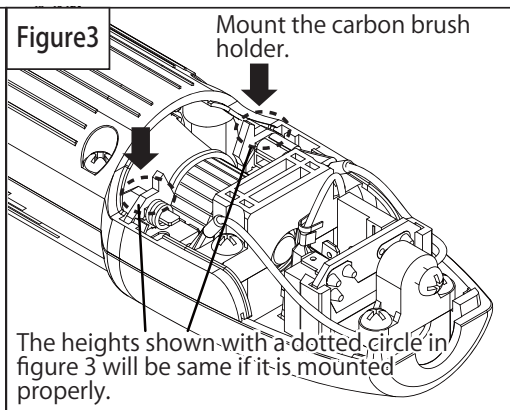
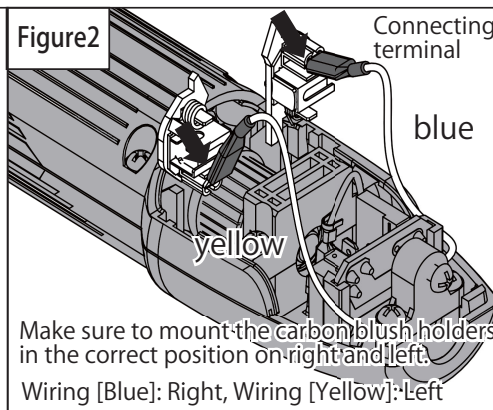
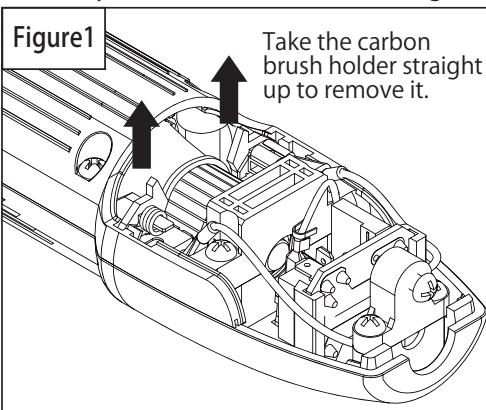
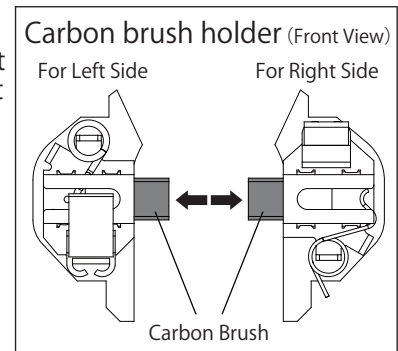

3. Inspect screws on the tools

Remove the tail cover and clean the filter periodically.

4. Motor Handling

Run the motor without load after using the machine for about 50 hours, and blow dry air through the air holes on the tail cover to remove dust and dirt. Run the motor without load after using the machine for about 50 hours, and blow dry air through the air holes on the tail cover to remove dust and dirt.

5. Machine / Accessories Storage

Machine / Accessories Storage Make sure use the carbon brush holder specified by NRS.

- × Easily accessible by children
- × Exposed to the rain or dampness
- × Damp condition is variable
- × Exposed to direct sunlight
- × Store inflammable material
- × Exposed to the risk of dropping